

# Model 550 OPERATING MANUAL

---



## Product Overview

The Model 550 is a linear amplifier designed to drive a number of different Conoptics Electro-Optic Modulators. The amplifier is AC coupled and is designed to accept bipolar input signal formats.

ConOptics, Inc. 19 Eagle Road, Danbury, CT 06810 Phone 800-748-3349 Fax 203-790-6145

Email: [sales@conoptics.com](mailto:sales@conoptics.com), or visit [www.conoptics.com](http://www.conoptics.com)

## CAUTION: BEFORE APPLYING POWER



Please review this manual and become familiar with all safety markings and instructions.

Insure that the equipment mains (line) voltage as specified on the rear panel is in accordance with desired AC source. Safe operation of this equipment may be jeopardized by use other than specified by Conoptics.

## INTENDED USE

This equipment is designed for general laboratory use. It is intended to be used with a number of Conoptics Electro-Optic Modulators only. The Model 550 amplifier is designed to drive a 50 ohm, Single Ended Line. Any use other than in direct connection with supplied optical modulators can result in severe damage to the amplifier. This amplifier must only be used in accordance with the instructions provided in the manual.

## WARNING: proper connections



The Model 550 amplifier is designed to work into a 50 ohm load only. Running the amplifier open circuit or into high VSWR loads will damage the amplifier

## SAFTEY GROUND

This equipment is equipped with a protective earth terminal. This terminal is provided by a common or ground wire in the power cord. The main power source must supply an uninterrupted return to an earth ground. The equipment must not be used if this earth return is not supplied.

### SERVICE CAUTION



Only qualified personnel must perform adjustment, maintenance, or repair of the equipment. Hazardous voltages are present within the instrument and contact may result in personal injury. Any attempt to trouble shoot or adjust any controls within the system should be discussed with Conoptics first at [support@conoptics.com](mailto:support@conoptics.com).

### Model 550 SYSTEM SPECIFICATIONS

Cabinet	Driver and power supply in single cabinet
Input Impedance	50 ohms

ConOptics, Inc. 19 Eagle Road, Danbury, CT 06810 Phone 800-748-3349 Fax 203-790-6145 Email: [sales@conoptics.com](mailto:sales@conoptics.com), or visit [www.conoptics.com](http://www.conoptics.com)

Gain	45 db
Max. Output Drive Level	125 v, p-p into 50 ohms
Detected Rise/Fall Time	Determined by modulator
Input Signal Format	Ac coupled bipolar signal, +10dbm max input level
Input Power (AC)	Typical, 360w
Dimensions	19" Rack Mountable,
Cooling	Forced air
Operating Environment	Designed for laboratory use (indoor only) Temperature range +5deg C to +50deg C ambient Humidity 20%-80% RH up to 32deg C, Altitude <3000M
Weight	20lbs (9.07kg)

## Connection Diagram

Model 550  
Amplifier

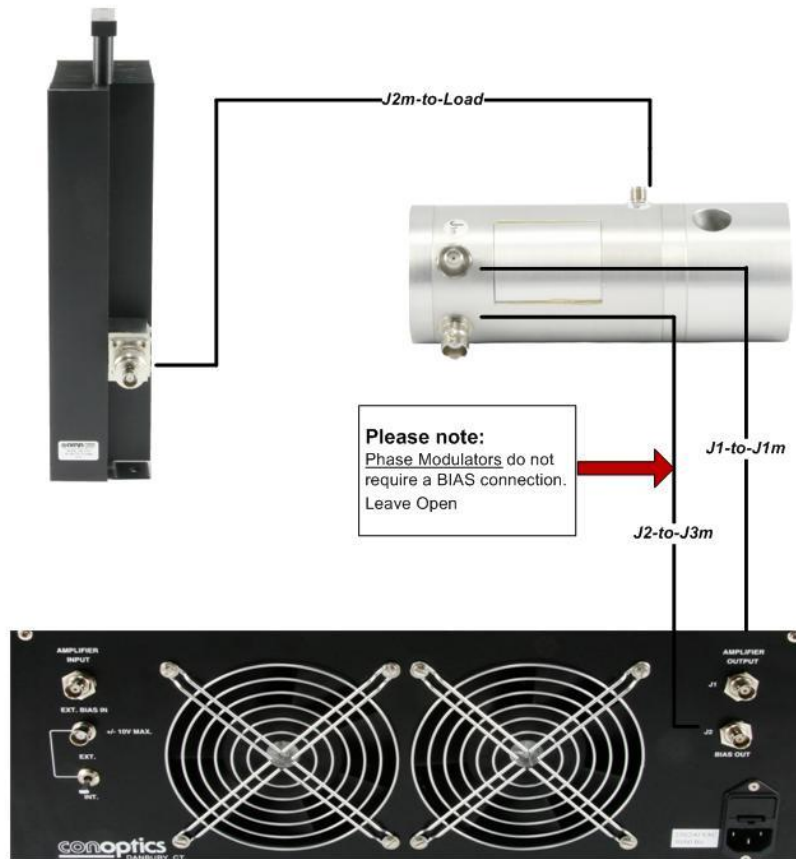

**Connection Key:**

- J1 Amp to J1m on Modulator
- J2 Amp to J3m on Modulator
- J2m on Modulator to LOAD

Model 550 Electronics

